

SUB-MINIATURE MINIMATIC® CYLINDER



SM-2

Single Acting



Did you know...

The tiny SM-2 cylinder gives 2 lbs of force at 100 psig.

Bore: 5/32"
Mount: Rear Thread
Type: Spring Return
Available Stroke Length: 1/4"
Materials: Stainless steel body, piston & rod, Buna-N U-cup, Beryllium copper spring

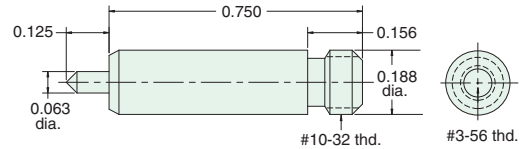

SM-3-□

Single Acting



Bore: 5/32"
Mount: Rear Thread
Type: Spring Return

Model	SM-3-1	SM-3-2	SM-3-3	SM-3-4
Stroke	1/4"	1/2"	3/4"	1"
Length "L"	0.740	1.171	1.593	2.000

Materials: Stainless steel tube and rod, brass piston, Buna-N U-cup

To order: Add stroke length to the end of the part number

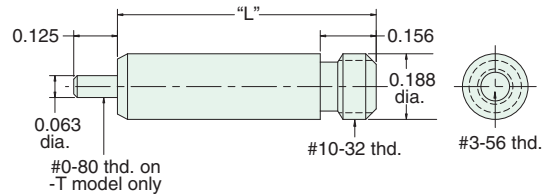

SM-6

Single Acting



Bore: 1/4"
Mount: Body
Type: Spring Return
Available Stroke Lengths: 3/8"
Materials: Brass body, Buna-N U-cup, stainless steel piston & rod

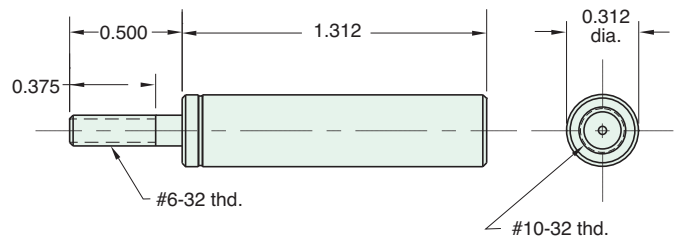

Nut included, but not shown on drawing

CUSTOMer solutions

If you need a product that fits your application perfectly, Clippard has the capability to design or modify one of its products to suit your exact needs. We understand that a standard catalog product may be close but not be exactly what you need. **Let us know YOUR Need, and we will help to find YOUR Solution!**

Special Configurations

This Clippard produced the first rolled-construction cylinder in 1949. Since then, we have produced thousands of special configurations from cartridge designs to low break-away **miniature cylinders**.

